

Sanitaryware schedule	Qty	Remarks
Doc M package	1	Document M standard RH packs (S6985) - blue grab rails
Back to wall wc's	2	Contour 21 BTW (S3056) - white
Urinals	6	Contour (S6110) - white
Handriers	4	Vent Axia prepdry stainless steel hand drier (20101440)
Tough wash hand basin	1	Corian construction

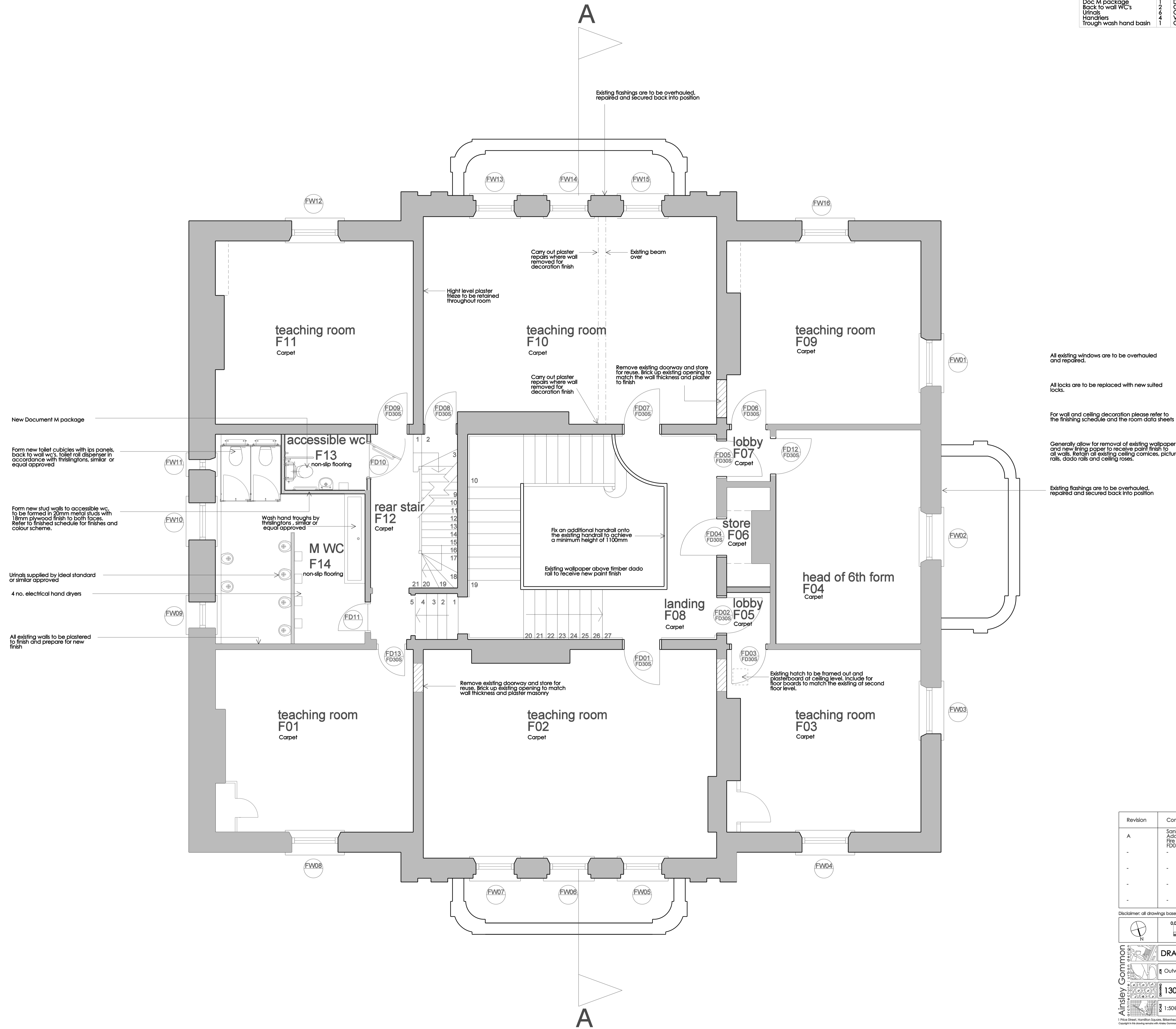

All existing windows are to be overhauled and repaired.

All locks are to be replaced with new suited locks.

For wall and ceiling decoration please refer to the finishing schedule and the room data sheets

Generally allow for removal of existing wallpaper and new lining paper to receive paint finish to all walls. Retain all existing ceiling cornices, picture rails, dado rails and ceiling roses.

Existing flashings are to be overhauled, repaired and secured back into position

New Document M package

Form new toilet cubicles with top panels, back to wall wc's, toilet roll dispenser in accordance with Haringtons, similar or equal approved

Form new stud walls to accessible wc, to be formed in 20mm metal studs with 18mm plywood finish to both faces. Refer to finished schedule for finishes and colour scheme.

Wash hand troughs by Haringtons, similar or equal approved

Urinals supplied by Ideal standard or similar approved

4 no. electrical hand driers

All existing walls to be plastered to finish and prepare for new finish

Revision	Comments	Date
A	Sanitaryware schedule added to plans. Additional planning notes added to F10. Fire rating added to FD01, FD02, FD03, FD04, FD05, FD06, FD07, FD08, FD09, FD12 and FD13.	12.01.12
-	-	-
-	-	-
-	-	-
-	-	-

Disclaimer: all drawings based on survey drawings provided by Socio Building Surveying Consultancy

DRAWING STATUS: FOR PLANNING

Outwood House, St Anselms College

1309-300-003 First Floor Plan Proposed

1:50@A1 Nov '11 MP MK A

© 1998-2011 Anisley Common. All rights reserved. This drawing is the property of Anisley Common. It is not to be used for any other purpose without the written consent of Anisley Common. Check all dimensions on site in the event of any discrepancies. See also the Anisley Common website.